

INSTALLATION

HINT:

The procedure described below is for the RH side. Use the same procedure for both the RH and LH sides, unless otherwise specified.

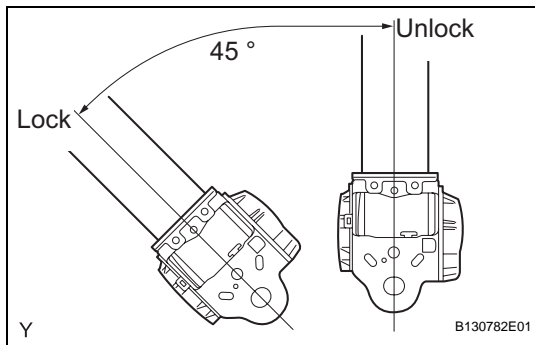

1. INSTALL REAR SEAT OUTER BELT ASSEMBLY

- (a) Check the angle of inclination required to lock the retractor.
 - (1) Gently incline the retractor from its initial position. Check that the belt does not lock when the retractor is inclined 15° or less in any direction. Also, check that the belt locks when the inclination of the retractor is 45° or more.

NOTICE:

Do not disassemble the retractor.

If the operation is not as specified, replace the rear seat outer belt.

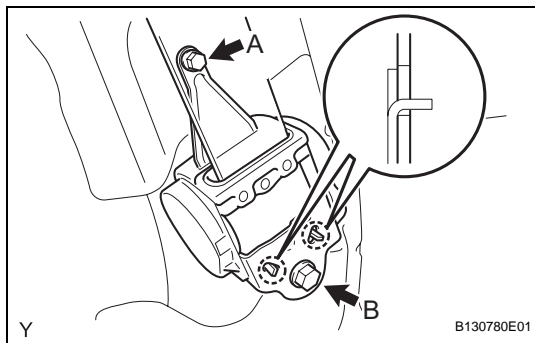

- (b) Hook the lower stay of the retractor onto the 2 body hooks and provisionally install the retractor with the 2 bolts.
- (c) Tighten bolt A and then bolt B.

Torque: 8.5 N*m (85 kgf*cm, 75 in.*lbf) for bolt A
42 N*m (430 kgf*cm, 31 ft.*lbf) for bolt B



- (d) Install the through anchor with the bolt.
- (e) Make sure that the shoulder anchor rotates smoothly.
- (f) Check that the ELR locks.

NOTICE:

Perform the check with the front seat outer belt installed.

- (1) With the belt installed, check that the belt locks when it is pulled out quickly.
If the operation is not as specified, replace the rear seat outer belt.

2. INSTALL ROOF SIDE INNER GARNISH (See page [IR-38](#))

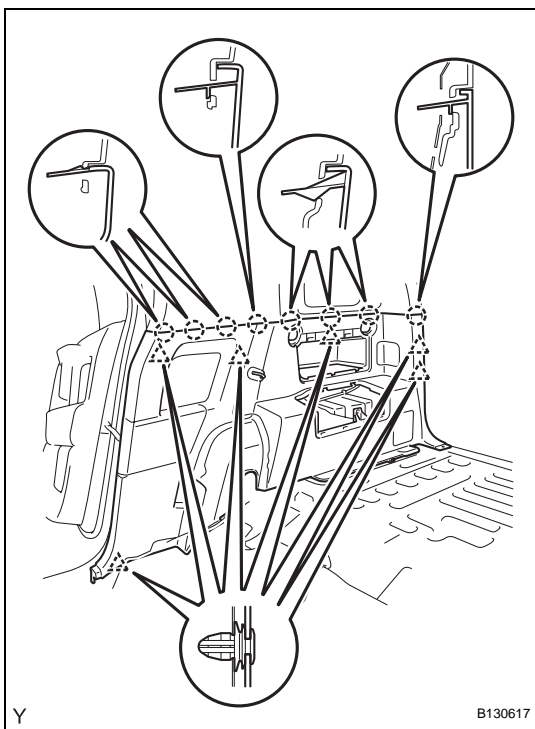

3. INSTALL DECK TRIM SIDE PANEL ASSEMBLY

(a) for RH Side:

- (1) Engage the 6 clips and the 8 claws and install the deck trim side panel.

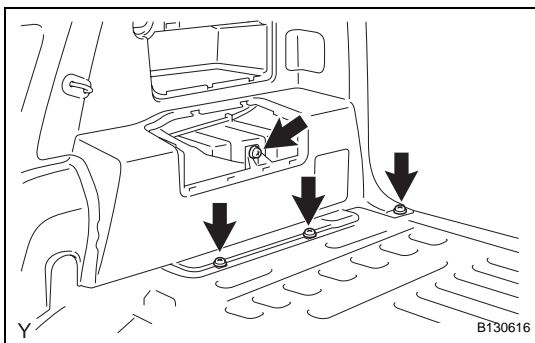

- (2) Tighten the 4 screws.

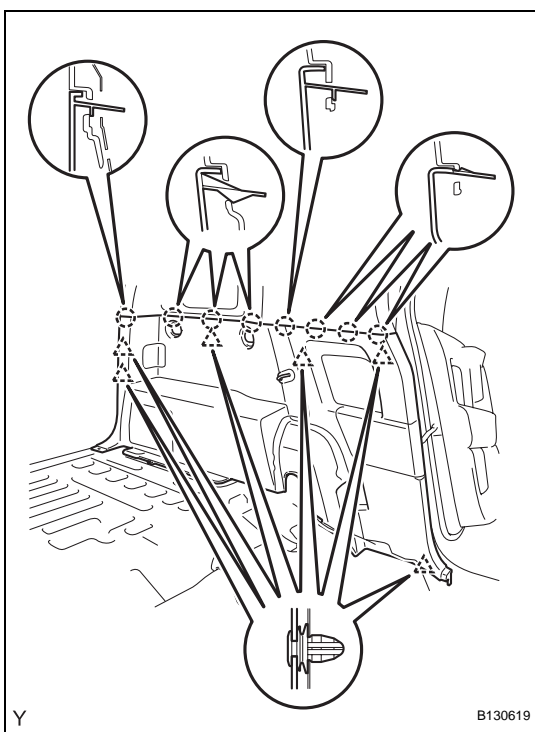

(b) for LH Side:

- (1) Engage the 6 clips and the 8 claws and install the deck trim side panel.

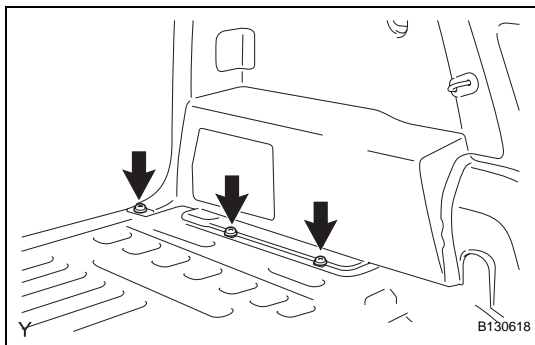

(2) Tighten the 3 screws.

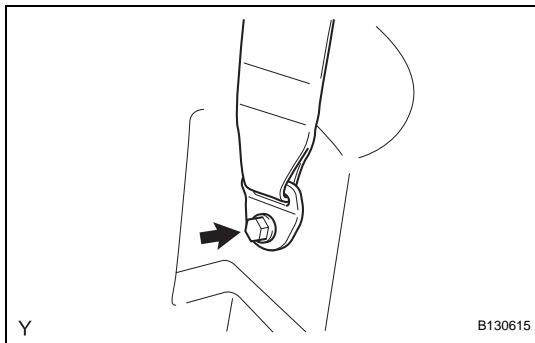

(c) Install the anchor plate with the bolt.

Torque: 42 N*m (430 kgf*cm, 31 ft.*lbf)

(d) Make sure that the shoulder anchor plate rotates smoothly.

4. INSTALL REAR DECK TRIM COVER (w/ Power Outlet Socket) (See page IR-40)

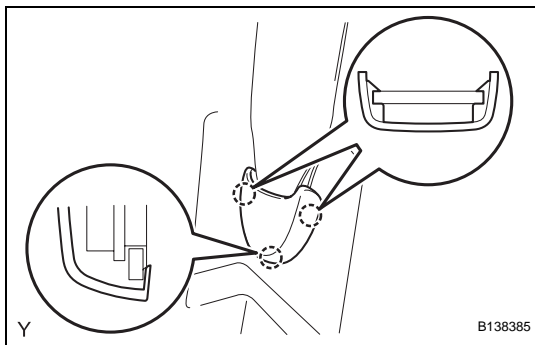

5. INSTALL LAP BELT OUTER ANCHOR COVER

(a) Engage the 3 claws and install the lap belt outer anchor cover.

6. INSTALL AMPLIFIER BOX SPEAKER ASSEMBLY (w/ Woofer) (See page AV-90)

7. INSTALL SPEAKER MOUNTING COVER (w/ Woofer) (See page AV-91)

8. INSTALL DECK SIDE GARNISH (w/ Woofer) (See page IR-41)

9. INSTALL QUARTER TRIM POCKET (w/o Woofer) (See page IR-41)

10. INSTALL SIDE TRIM COVER (w/o Woofer) (See page IR-42)

11. INSTALL QUARTER TRIM POCKET TRAY (w/o Woofer) (See page IR-42)

12. INSTALL PACKAGE HOLDER NET HOOK (w/o Woofer)

HINT:

Use the same procedure for both sides.

(a) Install the package holder net hook with the screw.

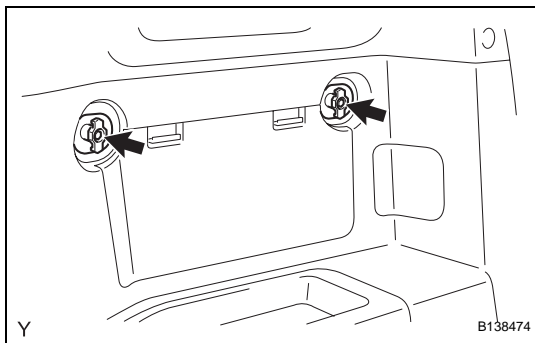

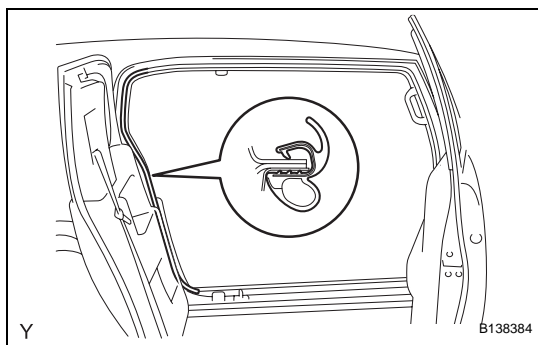

- 13. INSTALL FRONT DOOR OPENING TRIM WEATHERSTRIP**
 - (a) Install the front door opening trim weatherstrip.
- 14. INSTALL ACCESS DOOR SCUFF PLATE (See page IR-45)**
- 15. INSTALL FRONT DOOR SCUFF PLATE (See page IR-45)**
- 16. INSTALL REAR FLOOR MAT ASSEMBLY (See page IR-46)**
- 17. INSTALL LUGGAGE HOLD BELT STRIKER ASSEMBLY (See page IR-46)**
- 18. INSTALL REAR FLOOR MAT SUPPORT PLATE (See page IR-46)**
- 19. INSTALL REAR FLOOR BOARD (See page IR-47)**
- 20. INSTALL REAR SEATBACK ASSEMBLY**
 - (a) for RH Side:
 - (1) Install the rear seatback assembly (See page SE-54).
 - (b) for LH Side:
 - (1) Install the rear seatback assembly (See page SE-38).
- 21. INSTALL REAR SEATBACK BOARD CARPET ASSEMBLY**
 - (a) for RH Side:
 - (1) Install the rear seatback board carpet assembly (See page SE-54).
 - (b) for LH Side:
 - (1) Install the rear seatback board carpet assembly (See page SE-38).
- 22. CONNECT CABLE TO NEGATIVE BATTERY TERMINAL**

Torque: 3.9 N*m (40 kgf*cm, 35 in.*lbf)